

2024



SiS Series All in one Solar Street Light

SC-SiS SERIES 100W

The new range of luminaires for intelligent and future-safe road lighting. [Scowatt Lighting](#)



Your Green Energy Solution



Specially designed for Street lighting

- ☉ Good Anti theft Design
- ☉ High Quality
- ☉ High Performance
- ☉ Energy Costs
- ☉ Built-in Battery and Charger controller

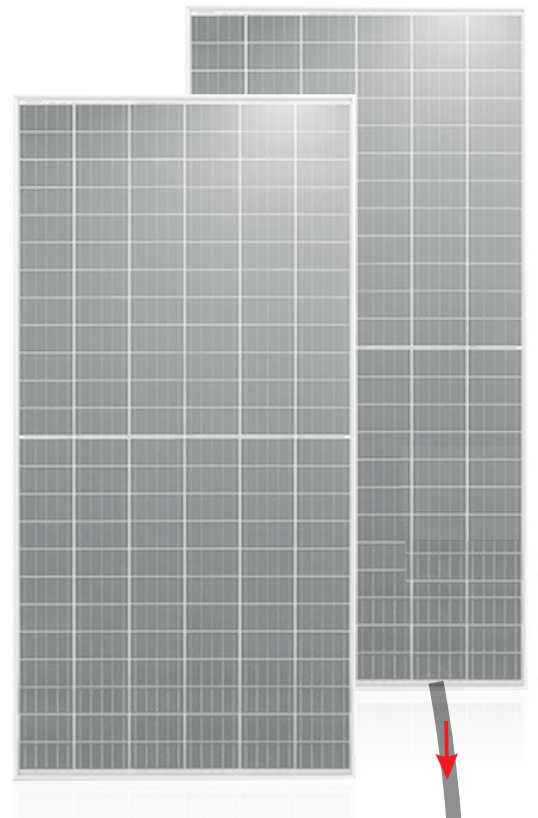
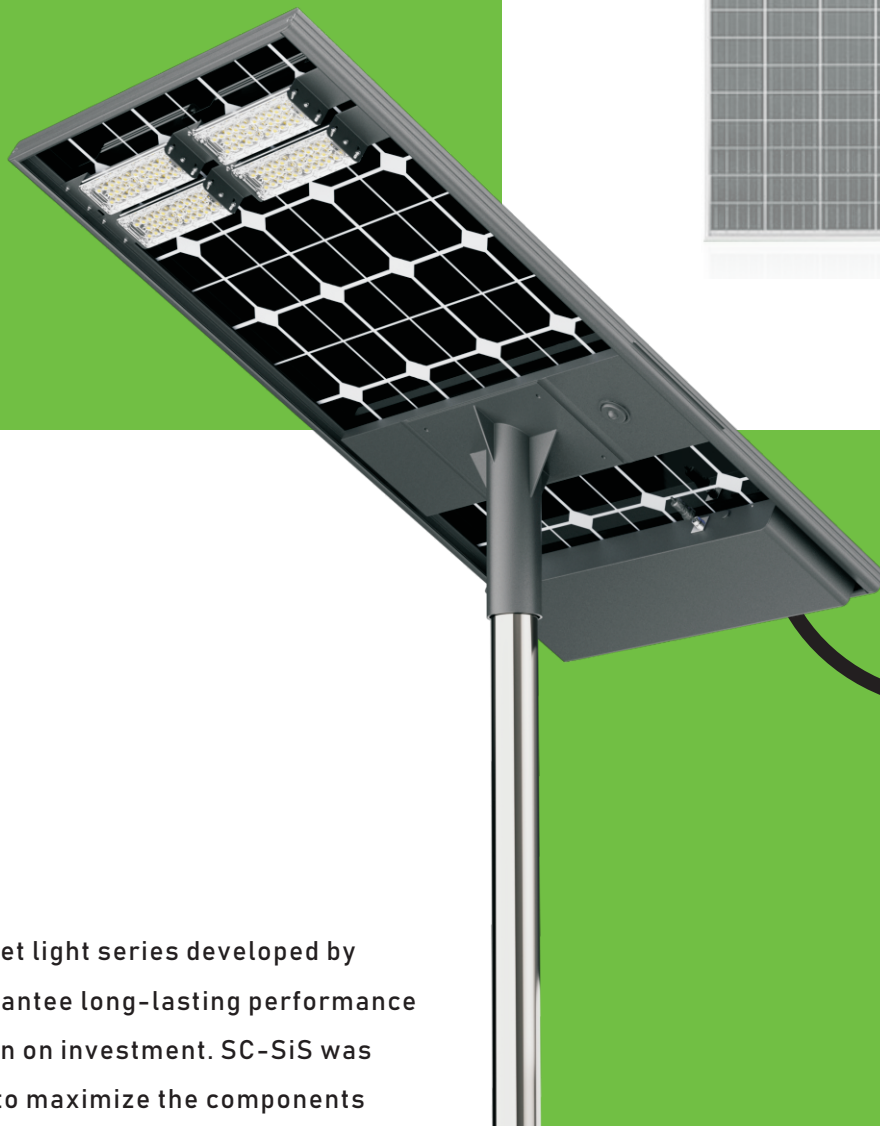

SC-SiS is a street light series developed by Scowatt to guarantee long-lasting performance and repaid return on investment. SC-SiS was born from need to maximize the components and to reduce the dimensions of the product, keeping the high performance.

Ecomagination At Work

SiS All in One Solar Street Light



Optical simulations help us building the project as we want

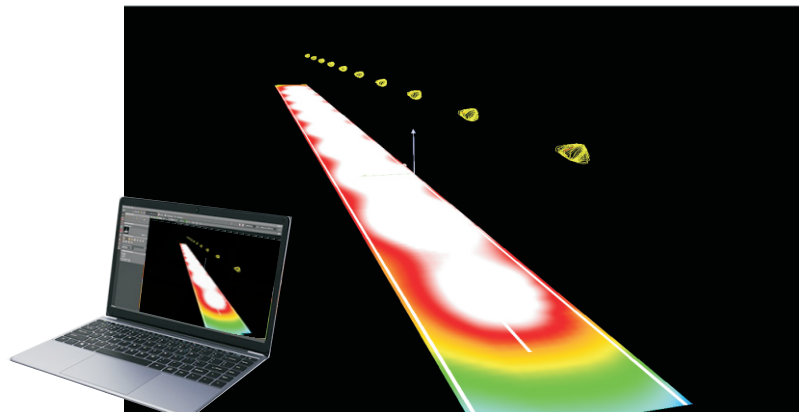
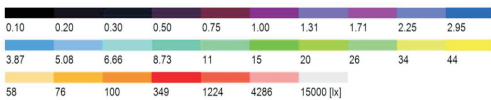
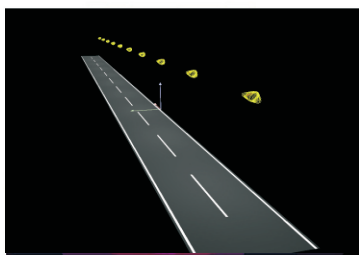
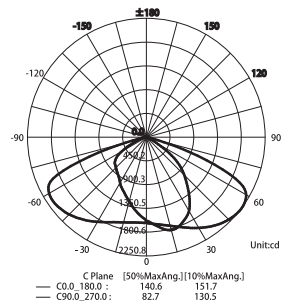
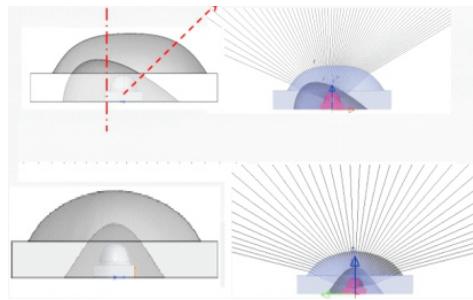
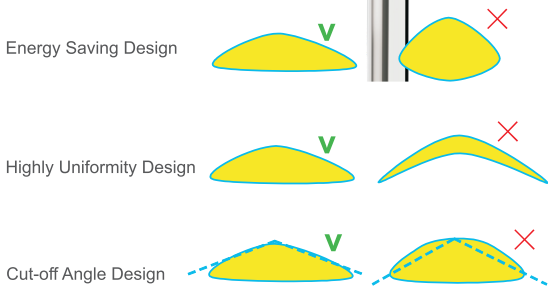

SC-SiS Series

A complete luminaire family with SOLAR ENERGY , an attractive design and modular technology

A high quality design of solar street light, It can adapt to any intelligent changes in the future, strong heat dissipation performance, stable structure design

IP66 Waterproof Rating Structure

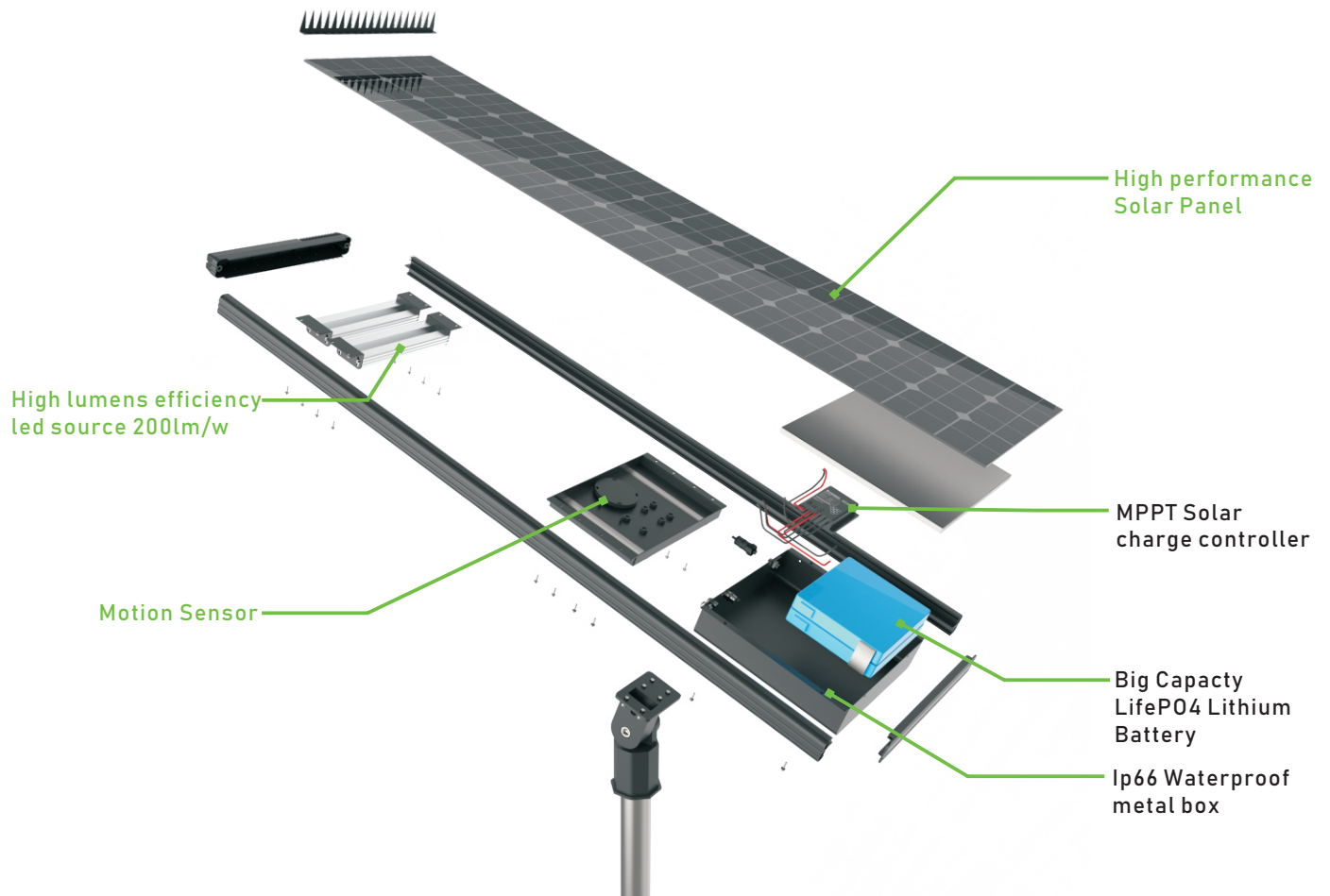

Tool-free,
Quick wiring terminal

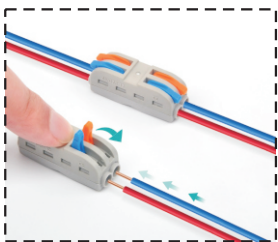

Perfect Die-casting heat sink Extend street light life-span

Design
(Perfect Die-casting Heat sink)

Using ADC12 standard aviation aluminum, with very high thermal conductivity, when the street light generates heat, it can quickly conduct and distribute the heat of the led chips, which reduces the heat of led chips, improves the life of the lam. Die-casting aluminum has a very stable structural design.

The modular design can replace the lamp parts in the future update projects and upgrade the intelligence, so that the parts can be reused, reduce the input cost and material waste, and protect the environment.

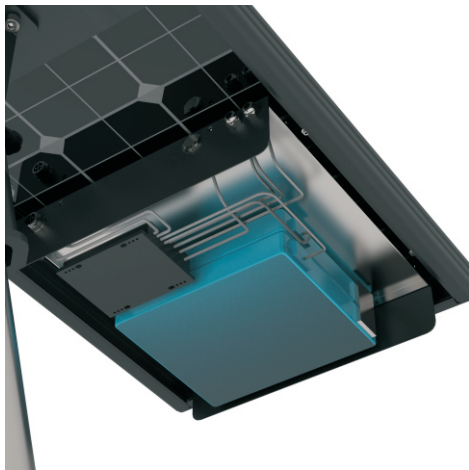

Your Advantages:



+



+



+



Up to 50%
energy savings

Extend LED 50% Lifetime
and reduce maintenance cost

Everything is
under control

Reduce light pollution
and CO₂ emissions

We Provide Local Solution

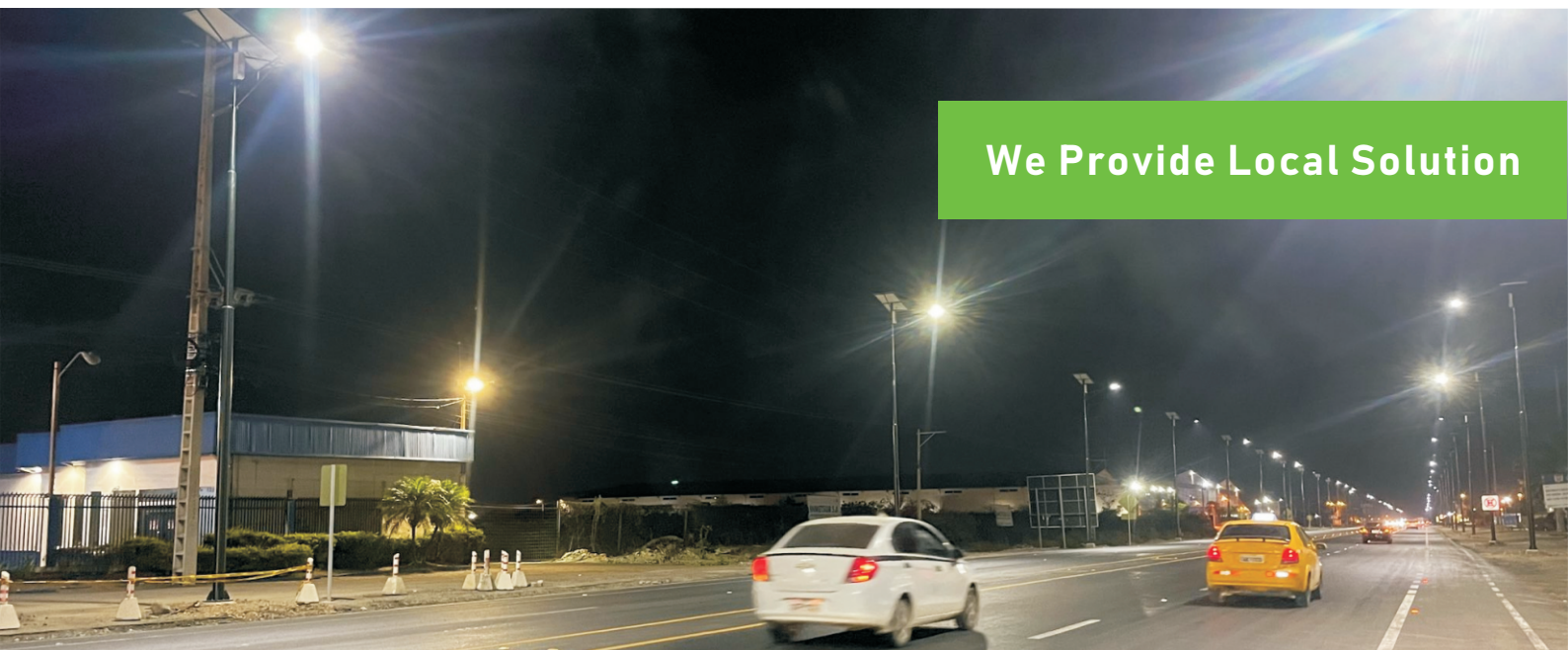

Remote control & Communication

Design

(Can add smart device in future)

Use the remote, the user can query the working state of the solar street light anytime . If the operation was not working perfect, the working parameters of the street light can be modified through the remote , including voltage, current, power, working time, etc. at the same time, it can also feed back the faults of the solar street light, so that the user can complete the maintenance without dismantling the lamp.



Function

Items	Specificationh	By Remote
Parameter Setting	Reset output power, voltage, current, working time	✓
Test street light	Turn on/ off the light , can show 30%/50%70%100% brightness	✓
Acceptance Project	Turn off the light , the light will work from next night with full battery capacity	✓
Failure feedback	Communicate operating status, will show you error code	✓

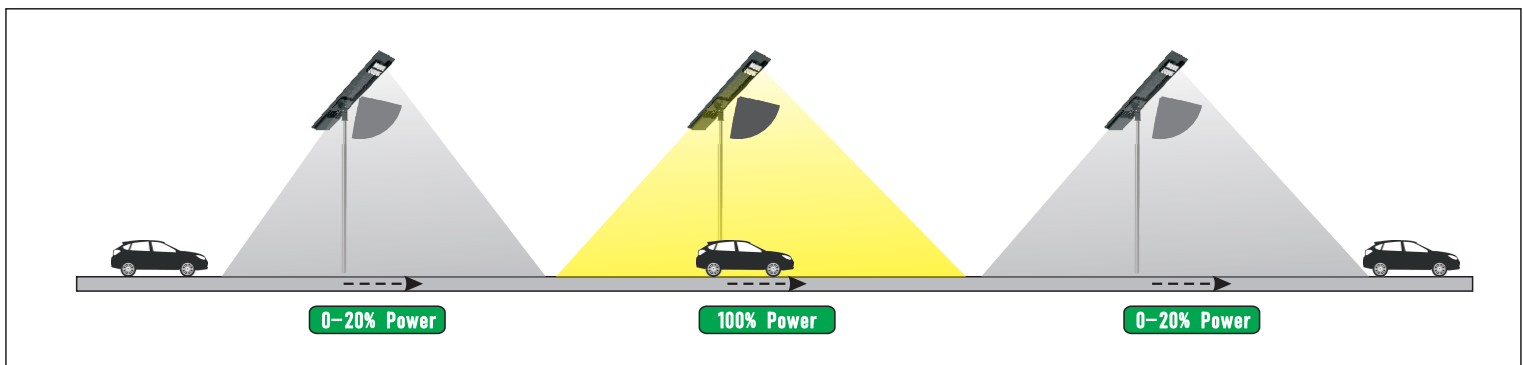

SiS All in one Solar Street Light

Technical Specification



Model	SC-SiS-100W
-------	-------------

System Data

Rating Power	100W
System volt	24V
Max lumens	18,500lm
Charge time	6 hrs
Default working mode	50% brightness with no motion detected,100% with motion detected Dusk to Dawn
Mounting height	6-10m
Lamp Size	1340*800*420mm
Lamp weight	44kg
IP Rating	IP66
Wind Load Rate (kph)	218
Charge Temperature	-20°C ~ 70°C
Discharge Temperature	-20°C ~ 70°C

Led Modular

Rating power	100W
Material	Die-cast aluminum alloy shell + PMMA Lens
LED chips	LUMILEDS 5050 (Philips)
Led chips efficiency	185 lm/w
Initial luminous flux (Max power by dc)	18,500lm
Initial luminous flux (power by AC 220V)	16,200lm (165 lm/watt) Have AC-DC power loss 10-25%
Beam angle	75°*150°/60°/90°/ 120°/180°
CCT	3000K-5000K-6500K
Light Distribution	Type2 / Type 3
Lifetime	80,000 hrs Approval by LM-79, LM-80 report
Warranty	5 Years
Lifespan	>10 Years
Certificated / Test report	IEC 60598 / ROHS/CE/etc.

Solar Panel

Rating Power	220W + 5%
Types of Solar panel	Monocrystalline
Efficiency cell	20.31%
Certificated	ISO 9001 , ISO 14001 , TUV , CB , IEC 61215,EN60950
Warranty	10 Years
Lifespan	20 Years

Technical Specification



Model SC-SiS-80W

System Data

Controller

Charge type	MPPT(Embedded Motion Sensor IP66)
Charge current	20A
Max Power	Solar @ 400Watt , LED lamp @120Watt
Communication Protocol	USB / Bluetooth/Remote
Remote control	in 30m distance , read operation data and reset system parameter
System protection	Over current,Short circuit, Over voltage, Over discharge, Over heating , etc.
Warranty	3 Years
Lifespan	10 Years
Certificated / Test report	IEC 62109

Battery

Battery type	LifePO4 Lithium Battery
Capacity	25.6V 72ah,1792wh($\pm 5\%$)
Cycles times	>2000 cycles
Life time	>5 Years
Warranty	3 Years
Feature	Easy maintain , IP 66 Waterproof, Rust-protection Temperature, DoD/SoH,Charging Protocol.
Certificated / Test report	IEC62133 / CE

website : syntech-solutions.my

Syntech Solutions & Services Sdn Bhd

Address : AJ 109, Ground Floor, Batu Kawah New
Township, Jalan Batu Kawa, 93250 Kuching, Sarawak.
Tel : +6082 - 529717 / + 6082 - 456717
Email : general@syntech-solutions.my
Whatsapp: + 6010 - 8820717 / +6016 - 3820717

Project Reference

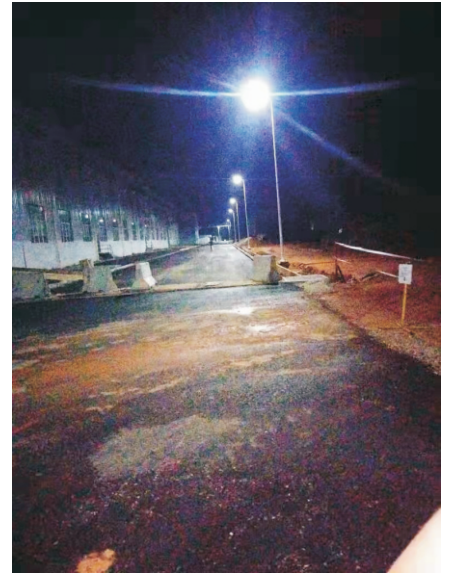

Contact Us for your best solution